

# LOTM16 - 16 UNIT OPEN TABLET/CHROMEBOOK CHARGING CART

**Product Specifications:**

Item Number	LOTM16
Material	Steel
Color Finish	Gray & White
Capacity	16 Tablets / Chromebooks
Cart Dimensions	27" W x 14.75" D x 30" H
Weight	37 lbs.
Shelf Quantity	One
Divider Make	Plastic (High Impact Polystyrene)
Divider Distance	1.35"
Divider Slot Dimensions	1.35" W x 8" D x 10.43" H
Cord Length	6'
Cable Management	Two cord clips per divider
Casters (4)	1.6" casters; two with locking brakes
Weight Capacity	75 lbs.
Power	16-outlet horizontal power strip UL Approved
Voltage	125V/15A
Ship Method	Ground
Shipping Carton Dims	One carton; 33" W x 18 D" x 5.25" H
Shipping Weight	41 lbs.
Assembly Required	Yes

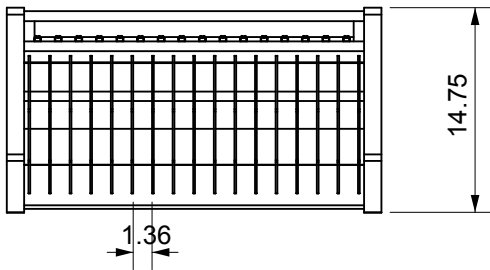
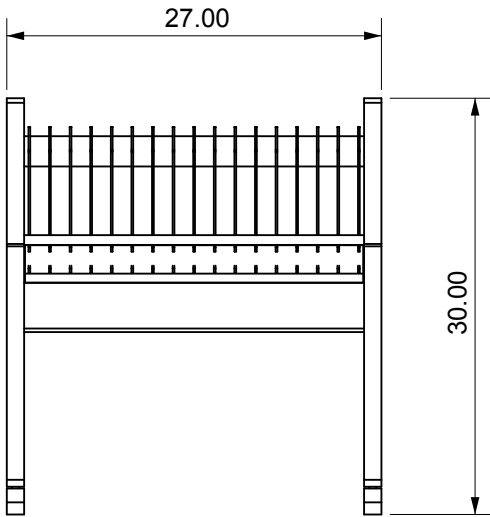
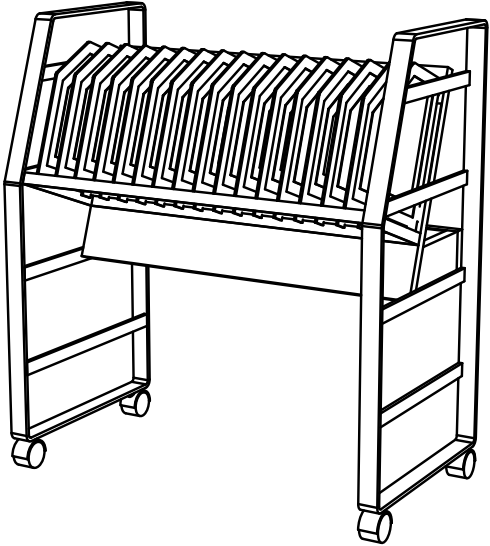

**To Order, Call Your Sales Representative or 800-323-4656**

2245 Delany Road, Waukegan, IL 60087  
 800-323-4656 | Fax 847-244-1818 | [www.LuxorFurn.com](http://www.LuxorFurn.com)

